



2



1



1



C



Description

Robert Luff & Co Lettings are pleased to offer to let this spacious two-bedroom first-floor flat, ideally located overlooking Portland Square in the heart of Worthing town centre.

The property offers two bedrooms, a bright and airy open-plan kitchen/lounge, and a modern bathroom. Further features include newly fitted carpets and a well-maintained building with weekly communal cleaning.

Perfectly positioned for easy access to shops, restaurants, bus routes, the mainline train station, and Worthing seafront, this flat is ideal for those seeking convenient town-centre living.



Key Features

- Two-bedroom first-floor flat
- Located in the heart of Worthing town centre
- Bright and airy open-plan kitchen and lounge area
- Modern bathroom
- Situated in a well-maintained building
- EPC Rating C
- Moments from shops, restaurants, bus routes
- Short walk to Worthing seafront
- Ideal for those seeking convenient town-centre living
- Zone A permit parking



robertluff.co.uk

30 Guildbourne Centre, Worthing, West Sussex, BN11 1LZ | 01903 331247 | info@robertluff.co.uk

Robert
Luff & Co



robertluff.co.uk

30 Guildbourne Centre, Worthing, West Sussex, BN11 1LZ | 01903 331247 | info@robertluff.co.uk

Robert
Luff & Co



Floor Plan Portland Road

Ground Floor

Approx. 45.4 sq. metres (488.3 sq. feet)

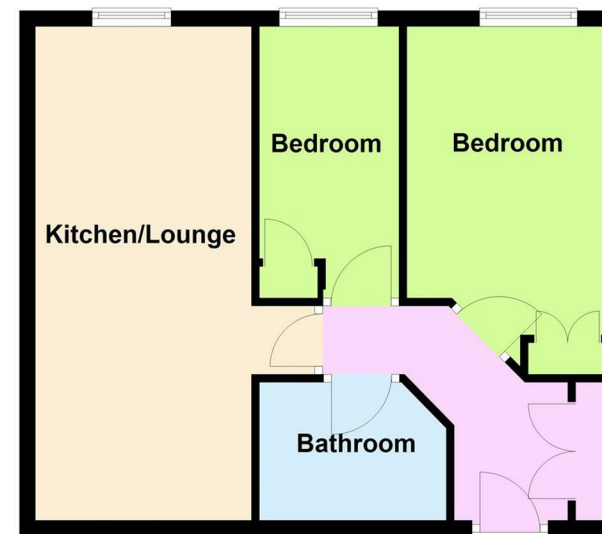

Total area: approx. 45.4 sq. metres (488.3 sq. feet)

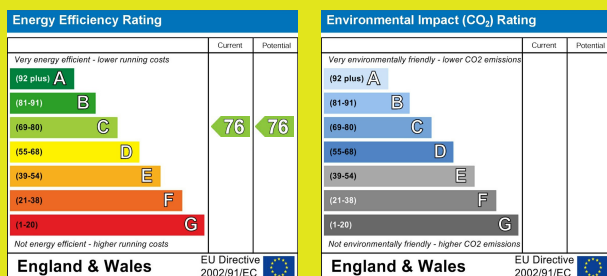

The information provided about this property does not constitute or form any part of an offer or contract, nor may it be regarded as representations. All interested parties must verify accuracy and your solicitor must verify tenure/lease information, fixtures and fittings and, where the property has been extended/converted, planning/building regulation consents. All dimensions are approximate and quoted for guidance only as are floor plans which are not to scale and their accuracy cannot be confirmed. References to appliances and/or services does not imply that they are necessarily in working order or fit for the purpose.

robertluff.co.uk

30 Guildbourne Centre, Worthing, West Sussex, BN11 1LZ | 01903 331247 | info@robertluff.co.uk

Robert
Luff & Co